



THE OHIO STATE UNIVERSITY

**The 30th North American Conference on Chinese Linguistics  
(NACCL-30)**



<b>Pre-Conference Workshops: Data Collection &amp; Corpora</b> <b>Date:</b> 8 March 2018, 2:30 - 7:00 p.m. <b>Venue:</b> <a href="#">Mershon Center</a> 1501 Neil Avenue, Columbus, Ohio 43201	<b>NACCL-30 Conference</b> ( <a href="https://u.osu.edu/naccl30/">https://u.osu.edu/naccl30/</a> ) <b>Dates:</b> 9-11 March 2018 <b>Venue:</b> <a href="#">The Blackwell Inn and Pfahl Conference Center</a> 2110 Tuttle Park Place, Columbus, Ohio 43210
---	--

**Friday, 9 March 2018**

8:00-8:30	<b>Coffee/Tea &amp; Refreshments</b> (Ballroom Lobby) <b>On-Site Registration &amp; Pre-Registration Packet Pick-Up: 8:00-9:30</b>
8:30-8:45	<b>Welcoming Remarks</b> (Ballroom BC) NACCL-30 Organizing Committee Faculty Co-Chairs Professor Valarie Williams, Associate Dean for Outreach and Engagement, College of Arts and Sciences
8:45-9:45	<b>Plenary Session A: Keynote Speaker</b> (Ballroom BC) Chair: Professor Brian Joseph (Dept. of Linguistics, OSU) <b>Professor Emeritus Mary E. Beckman, The Ohio State University</b> The Sociophonetics of Gender in Three Chinese Varieties
9:45-10:00	<b>Coffee/Tea Break</b> (Pfahl Third Floor Foyer)
9:45-11:30	<b>On-Site Registration &amp; Pre-Registration Packet Pick-Up</b> (Pfahl Third Floor Foyer)

<b>Fri. 03/09/2018 Session 1. 10:00-11:30</b>				
	<b>Session 1-A</b> (Pfahl 302) Language Acquisition I	<b>Session 1-B</b> (Pfahl 330) Phonetics & Phonology I	<b>Session 1-C</b> (Pfahl 340) Tense & Aspect	<b>Session 1-D</b> (Pfahl 102) Syntax of Questions
	Chair: Wu, Sue-mei	Chair: Li, Aijun	Chair: Tang, Sze-Wing	Chair: Liu, Hongyong
10:00-10:30	<b>Xiang, Jingting &amp; Yuan, Boping</b> (U of Cambridge) The L3 acquisition of definiteness and specificity in Mandarin by English-Cantonese bilinguals	<b>Lin, Yen-Hwei</b> (Michigan State U) Yanggu diminutive <i>er</i> affixation Revisited	<b>Grano, Thomas</b> (Indiana U) Getting the progressive under control: Mandarin vs. English	<b>Wei, Ting-Chi</b> (National Kao-hsiung Normal U) Split questions in Chinese: A biclausal analysis
10:30-11:00	<b>Zhao, Shuyan &amp; Zhou, Peng</b> (Tsinghua U) Logical mind of smaller people: children's understanding of implicatures	<b>Li, Guo &amp; Shi, Xinyuan</b> (Chinese U of Hong Kong) The effect of boundary on syllable duration in Mandarin: a preliminary study	<b>Wang, Jixin</b> (U of Tübingen) A unified semantic account of particle <i>-le</i> in Mandarin Chinese: A type-driven compositional approach	<b>Cheng, Hsu-Te</b> (Emory U) Opaque domains in A-not-A questions
11:00-11:30	<b>Kuo, Chien-Min</b> (National Taiwan Normal U) Mandarin-speaking children's mechanisms for simplifying CVC syllables in Mandarin	<b>Fung, Roxana S. Y. &amp; Lee, Chris</b> (Hong Kong Polytechnic U) Voice quality and identity: The case of Hong Kong Cantonese	<b>Shang, Xin</b> (Shanghai Maritime U) & <b>Xie, Zhiguo</b> (Ohio State U) A dynamic perspective of <i>Le</i> <sub>1</sub> -marked event sentences in Chinese: Temporal semantics, syntax and their interface	<b>Chen, Zhuo</b> (U of California, Los Angeles) Revisiting the surface position of Mandarin A-not-A constructions
11:30-1:00	<p align="center"><b>Free Time</b></p> <p align="center"><i>Bistro 2110 at The Blackwell has buffet lunch (\$12.95/person) and menu items. In addition, there are restaurants and other eateries within walking distance.</i></p>			
1:00-6:00	<p align="center"><b>On-Site Registration &amp; Pre-Registration Packet Pick-Up</b> (Pfahl Third Floor Foyer)</p>			

Fri. 03/09/2018 Session 2. 1:00-2:30				
	<b>Session 2-A</b> (Pfahl 302) Grammaticalization	<b>Session 2-B</b> (Pfahl 330) Historical Linguistics I	<b>Session 2-C</b> (Pfahl 340) Language Acquisition II	<b>Session 2-D</b> (Pfahl 102) Dialectology I
	Chair: Kuo, Pei-Jung	Chair: Eom, Ik-sang	Chair: Yuan, Boping	Chair: Chin, Andy
1:00-1:30	<b>Tao, Liang</b> (Ohio U) Grammaticalization in the making: From production to comprehension in Chinese	<b>Zhang, Zheng-sheng</b> (San Diego State U) A multi-dimensional perspective on Classical Chinese elements	<b>Yang, Jenny Yuan-Chen</b> (Rutgers U)  The semantics and pragmatics of Mandarin Chinese for L2 learners	<b>惠红军</b> (Xi, Hongjun) (陕西师范大学) 汉语方言名词重叠式的极性指称功能
1:30-2:00	<b>Dong, Hongyuan</b> (George Washington U) A semantic analysis of <i>-ne</i> as a topic marker: A grammaticalization perspective	<b>Hu, Hai</b> (Indiana U) English acronyms in Chinese texts: Diachronic change and synchronic prediction	<b>Xia, Alice</b> (Carleton U) Effect of proficiency on Chinese character processing strategy in foreign language learners	<b>王苗</b> (Wang, Miao) (广州大学) 论汉语方言中复数标记的有定性及其语法化
2:00-2:30	<b>葛平平</b> (Ge, Pingping) (南京大学) “x 加”类程度标记的词汇化轨迹、动因与机制	<b>Bowman, Frederick</b> (Ohio State U) A study of medieval vernacular Sinitic <i>fēi shì</i> and <i>wú yǒu</i>	<b>Li, You</b> (U of Illinois at Urbana-Champaign) Directionality effects on L2 sentence build-up drills in Mandarin	<b>汤丽</b> (Tang, Li)、 <b>许又尹</b> (Hsu, Yu-Yin) (香港理工大学) 重庆方言句末语气词句法结构分析
2:30-2:45	<b>Coffee/Tea Break</b> (Pfahl Third Floor Foyer)			

<b>Fri. 03/09/2018 Session 3. 2:45-4:15</b>				
	<b>Session 3-A</b> (Pfahl 302) Syntax I	<b>Session 3-B</b> (Pfahl 330) Morphophonology	<b>Session 3-C</b> (Pfahl 340) Sociolinguistics & Socio-pragmatics	<b>Session 3-D</b> (Pfahl 102) Dialectology II
	Chair: Grano, Thomas	Chair: Lin, Yen-hwei	Chair: Tao, Hongyin	Chair: Zhang, Zheng-sheng
2:45-3:15	<b>Tang, Sze-Wing</b> (Chinese U of Hong Kong) Cartographic syntax of speech act: Evidence from Cantonese	<b>Li, Qian; Luo, Yingyi &amp; Li, Aijun</b> (Chinese Academy of Social Sciences) Revisiting the perception of T3 sandhi in Standard Chinese—Evidence from eye movements	<b>Lau, Helena Yan Ping &amp; Lee, Sophia Yat Mei</b> (Hong Kong Polytechnic U) Information-seeking questions and rhetorical questions in social media	<b>Chin, Andy</b> (Education U of Hong Kong) Discourse markers in Cantonese
3:15-3:45	<b>Hsu, Yu-Yin</b> (Hong Kong Polytechnic U) A survey on exhaustivity and focus	<b>Wang, Xiaopei</b> (Guangdong U of Foreign Studies) Locality and the spell-out of reduplicated words in Pingyao dialect	<b>Su, Yunwen</b> (Case Western Reserve U) Yes or no: Responding to invitations and offers in Chinese	<b>劉擇明</b> (Lau, Chaak-ming) (香港中文大學) 粵語句末助詞「aa3」的三種長度變體
3:45-4:15	<b>Wu, Hongchen &amp; Larson, Richard</b> (Stony Brook U) Topicality and quantifier scope in Mandarin	<b>Zhou, Yihan</b> (U of Illinois at Urbana-Champaign) What decides the morphemic sequence in Chinese disyllabic coordinated compounds: A corpus study of words of reversed morphemes	<b>Chou, Ying-Hsiu</b> (U of Washington) The innovative uses of symbols on PTT	<b>Zhu, Yuhong</b> (Ohio State U) Diachrony of coda /ŋ/ in Suzhou, Wu Chinese: Generational change and differing readings
4:15-4:30	<b>Coffee/Tea Break</b> (Pfahl Third Floor Foyer)			

<b>Fri. 03/09/2018 Session 4. 4:30-6:00</b>				
	<b>Session 4-A</b> (Pfahl 302) Syntax II	<b>Session 4-B</b> (Pfahl 330) Discourse Analysis & Pragmatics I	<b>Session 4-C</b> (Pfahl 340) Tonal Phenomena	<b>Session 4-D</b> (Pfahl 102) Morphosyntax
	Chair: Lin, C-J Charles	Chair: Chiang, Mien-Hwa	Chair: Dong, Hongyuan	Chair: Liu, Chen-Sheng
4:30-5:00	<b>Wei, Wei &amp; Li, Audrey</b> (U of Southern California) The internal and external syntax of adverbial clauses in Chinese	<b>Tao, Hongyin</b> (U of California, Los Angeles) Corpus evidence for frequency effects on de-neutralized expressions: Toward a usage-based perspective on meaning and meaning change	<b>Yang, Chunsheng</b> (U of Connecticut) Categorical perception of Mandarin tones by L1 and L2 speakers	<b>覃业位</b> (Qin, Yewei) (武汉大学) 新兴多重重叠式 VVVO 的句法语义结构
5:00-5:30	<b>Kuo, Pei-Jung</b> (National Chiayi U) Spatial Phrases in the VP and TP domains in Mandarin Chinese	<b>Gao, Xuefeng &amp; Lee, Sophia Yat Mei</b> (Hong Kong Polytechnic U) How do discourse markers indicate emotions?	<b>Zhang, Yubin</b> (Hong Kong Polytechnic U) Variation in Cantonese Tone 4 and Tone 6 perception	<b>李占</b> (Li, Zhan) (北京教育学院) 基于语料库的动词重叠使用分析
5:30-6:00	<b>Cong, Yan</b> (Michigan State U) The non-canonical argument realization of Chinese alternations	<b>Lu, Xiaolong</b> (U of Hawaii at Manoa) On the case of <i>zheyangzi</i> in Mandarin words of Taiwan and Mainland China	<b>Zhou, Yingyi</b> (Hong Kong U of Science and Technology) A phonation-induced tonal evolution — A case study of entering tone in Zhajin Gan	<b>申甜</b> (Shen, Tian) (上海交通大学) 现代汉语形名组合中反义形容词偶的标记性与能产性研究
6:00-	<p align="center"><b>Free Time</b></p> <p align="center"><i>Bistro 2110 at The Blackwell serves dinner from the menu. In addition, there are restaurants and other eateries within walking distance.</i></p>			

## **Saturday, 10 March 2018**

8:15-8:45	<b>Coffee/Tea &amp; Refreshments</b> (Ballroom Lobby)
8:45-9:45	<b>Plenary Session B: Special Guest</b> (Ballroom BC) Chair: Professor Mineharu Nakayama (Dept. of E. Asian L&L, OSU) <b>Professor James H-Y. Tai (戴浩一), National Chung Cheng University</b> Neural Plasticity and Learning Chinese as a Second Language
9:45-10:00	<b>Coffee/Tea Break</b> (Pfahl Third Floor Foyer)
9:45-12:00	<b>On-Site Registration &amp; Pre-Registration Packet Pick-Up</b> (Pfahl Third Floor Foyer)

Sat. 03/10/2018 Session 5. 10:00-12:00				
	Session 5-A (Pfahl 302) Semantics & Pragmatics	Session 5-B (Pfahl 330) Experimental Research I	Session 5-C (Pfahl 340) Dialects, Loan Words & Ethnic Minority Languages	Session 5-D (Pfahl 102) Historical Linguistics II
	Chair: Shang, Xin	Chair: Duanmu, San	Chair: Lee, Ok Joo	Chair: Fung, Roxana Suk Yee
10:00-10:30	<b>Tian, Yu &amp; Liu, Feng-hsi</b> (U of Arizona) The <i>ba</i> construction and NP interpretations	<b>Yan, Shanshan &amp; Yuan, Boping</b> (U of Cambridge) English speakers' L2 acquisition of the Chinese aspectual sentence-final particle <i>ne</i>	<b>Huang, Ho-Hsin &amp; Lin, Yen-hwei</b> (Michigan State U) Variation of nasal gemination in Standard Mandarin loanwords: Corpus, Experimental and Theoretical Perspectives	<b>Eom, Ik-sang</b> (Hanyang U) Chinese and Korean: Relationship through typological comparisons
10:30-11:00	<b>Liu, Chen-Sheng Luther</b> (National Chiao Tung U) The quantity adjective LIHAI in Chinese	<b>Zhu, Jingtao</b> (Universitat Autònoma de Barcelona / ClicAsia, Centre d'Estudis Orientals) & <b>Gavarró, Anna</b> (Universitat Autònoma de Barcelona) The setting of the Null Topic Parameter in Mandarin-speaking children	<b>Alves, Mark</b> (Montgomery College) Chinese loanwords in the Vietnamese system of color terms	<b>Wu, Sue-mei</b> (Carnegie Mellon U) The special characteristics of Classical Chinese and the grammatical particles: Applications to ancient fables
11:00-11:30	<b>Li, Xiao</b> (Queens College, CUNY) Measurement scales and gradability: On the semantics of the possessive property concept construction in Mandarin Chinese	<b>Zhang, Yiwen; Hu, Hai &amp; Lin, Chien-Jer Charles</b> (Indiana U) Expectations in reading Chinese verbs with ambiguous complement structures	<b>刘春陶</b> (Liu, Chuntao) (南开大学) 崖城军话共时韵母系统内的链式音变	<b>Chen, Litong</b> (U of Mount Union) Behind literature hides linguistics: Character frequency and rhyme occurrence correlation in <i>Huajian-Ji</i>
11:30-12:00	<b>Wang, Qian</b> (Ohio State U) Not always positive: Bare gradable adjectives' interpretation in Mandarin polar questions	<b>Chen, Yunchuan &amp; Fukuda, Shin</b> (U of Hawaii at Manoa) Is there subject-object asymmetry in acceptability of the resumptive pronoun <i>ta</i> inside Chinese relative clauses?	<b>黄静露</b> (Huang, Jinglu) (广西民族大学) 古汉语声类在壮语汉字音中的历史演变	<b>陳遠秀</b> (Chan, Yuen Sau) (香港中文大學) 定州漢簡《文子》「奈何之」句法分析

**Sat. 03/10/2018** *(continued)*

12:00-1:30	<p><b>Free Time</b></p> <p><i>Bistro 2110 at The Blackwell has buffet lunch (\$12.95/person) and menu items. In addition, there are restaurants and other eateries within walking distance.</i></p>
1:30-2:30	<p><b>Plenary Session C: Keynote Speaker</b> (Ballroom BC) Chair: Professor Marjorie K.M. Chan (Dept. of E. Asian L&amp;L, OSU)</p> <p><b>Professor Chu-Ren Huang (黄居仁), Hong Kong Polytechnic University</b></p> <p>Chinese Perspectives on Synaesthesia: From Sense to Sense, from Cognition to Culture, from Embodiment to Universality</p>
2:45-5:00	<p><b>On-Site Registration &amp; Pre-Registration Packet Pick-Up</b> (Pfahl Third Floor Foyer)</p>



Sat. 03/10/2018 Session 6. 2:45-4:45				
	Session 6-A (Pfahl 302) Experimental & Corpus Research I	Session 6-B (Pfahl 330) Phonetics & Phonology II	Session 6-C (Pfahl 340) Syntax & Semantics I	Session 6-D (Pfahl 102) Language Change
	Chair: Yang, Chunsheng	Chair: Wiener, Seth	Chair: Liu, Feng-hsi	Chair: Hsu, Yu-Yin
2:45-3:15	<b>Wu, Zhuang</b> (Guangdong U of Foreign Studies) Acquisition of the scalar reading of <i>dou</i> by Mandarin-speaking children	<b>Duanmu, San</b> (U of Michigan) Choosing the best phonemic analysis: Evidence from Chengdu	<b>Chen, I-Hsuan; Long, Yunfei &amp; Huang, Chu-Ren</b> (Hong Kong Polytechnic U) Influence of semantically-encoded orthography on perception of Chinese sensory modalities	<b>Deng, Lin</b> (U of Nevada, Las Vegas) Toward a unified interpretation of the modal and the referential <i>Qi</i> 其
3:15-3:45	<b>Wang, Li, Wen, Zhen &amp; Zhao, Yingxia</b> (Nantong U) 基于语料库的汉语学习者动宾搭配特征研究	<b>Qin, Zuxuan</b> (Southwest Minzu U & U of Michigan) & <b>Duanmu, San</b> (U of Michigan) Word-length preferences in Chinese nominal VN compounds: A corpus study	<b>刘鸿勇</b> (Liu, Hongyong) (澳门大学) 汉语通用个体量词的情感态度义	<b>Zhang, Liulin</b> (Truman State U) Diachrony of Chinese marked/unmarked passive distribution in the paradigm of language modernization
3:45-4:15	<b>Xu, Xiaonan; Philipp, Markus; Graf, Tim &amp; Primus, Beatrice</b> (U of Cologne) On the interaction between agentivity and telicity in Chinese intransitive clauses	<b>Lee, Ok Joo</b> (Ewha Womans U / Seoul National U) The sounds of Mandarin: A typological account	<b>雷雨</b> (Lei, Yu) (西华盛顿大学) 汉语“一个 NP”指称性与句法位置的关系研究	<b>馬坤</b> (Ma, Kun) (中山大學) 上古漢語小舌聲母構擬中的問題
4:15-4:45	<b>Yu, Shuo</b> (Lancaster U) A corpus study of Chinese resultative constructions: a typological perspective	<b>时秀娟</b> (Shi, Xiujuan) (天津师范大学) 、 <b>温宝莹</b> (Wen, Baoying) (南开大学) 普通话基础元音“鼻化”的稳定与变化	<b>Liu, Xia</b> (U of Auckland) <i>tau</i> + VP and S + <i>tau</i> in the Xiaolongmen dialect of Hunan Province, China	<b>李艾倪</b> (Li, Aini) (上海交通大学) 成都话方位词词缀“-头/-面”的语言变异研究
4:45-5:00	Coffee/Tea Break (Pfahl Third Floor Foyer)			

**Sat. 03/10/2018** *(continued)*

5:00-6:00	<p><b>Plenary Session D: Keynote Speaker</b> (Ballroom BC)</p> <p>Chair: Professor Zhiguo Xie (Dept. of E. Asian L&amp;L, OSU)</p> <p><b>Professor Zhuo Jing-Schmidt (井苗), University of Oregon</b></p> <p>Counterfactual Emotions and Language: Cautionary Implications for Linguistic Relativity</p>
6:30-8:00	<p><b>BANQUET</b> (Ballroom BC)</p> <p><i>(For attendees who have paid at the time of registration)</i></p>

**The NACCL-30 Organizing Committee expresses our sincere thanks to our sponsors:**

**OSU Sponsors**

Office of Research	Department of East Asian Languages and Literatures
College of Arts and Sciences	Department of Linguistics
Division of Arts and Humanities	Department of Speech and Hearing Sciences
East Asian Studies Center	Buckeye Language Network
Center for Cognitive and Brain Sciences	Council on Student Affairs
Institute for Chinese Studies	Graduate Association of Chinese Linguistics
OCAPA Lecture Fund	Graduate Students of East Asian Languages and Literatures
Jerome G. Dare Fund	

**Donations**

Taiwan Center for Sign Linguistics, National Chung Cheng University

*This event is sponsored in part by a U.S. Department of Education Title VI grant for The Ohio State University East Asian Studies Center.*

## Sunday, 11 March 2018

**Note:** Daylight Saving Time 2018 in Ohio will begin at 2:00 AM on March 11. Move your clock/watch *forward* by one hour.

8:30-8:45	<b>Coffee/Tea &amp; Refreshments</b> (Pfahl Third Floor Foyer)
8:30-12:00	<b>On-Site Registration &amp; Pre-Registration Packet Pick-Up</b> (Pfahl Third Floor Foyer)

<b>Sun. 03/11/2018 Session 7. 8:45-10 :15</b>			
	<b>Session 7-A</b> (Pfahl 330) Syntax & Semantics II	<b>Session 7-B</b> (Pfahl 340) Experimental Research II	<b>Session 7-C</b> (Pfahl 240) Discourse Analysis & Pragmatics II
	Chair: Li, Xiao	Chair: Kang, Hana	Chair: Xi, Hongjun
8:45-9:15	<b>彭利贞</b> (Peng, Lizhen) (浙江大学) 焦点位置情态动词的语义	<b>Guo, Yanyu &amp; Yuan, Boping</b> (U of Cambridge) Feature unlearning in English Speakers' L2 acquisition of Chinese imperfective markers	<b>Chiang, Mien-hwa</b> (U of Pennsylvania) & <b>Yang, Lei</b> (Carleton College) 要是没有“她”：汉语女性第三人称代词的发展、认知与使用
9:15-9:45	<b>Hu, Suhua</b> (Minzu U of China & Harvard U) Resultatives in Nuosu Yi – Comparing to Mandarin and English	<b>Wang, Yiyi &amp; Wu, Di</b> (U of Illinois at Urbana-Champaign) Chinese Automated Essay Scoring using deep neural networks	<b>Zhou, Yan</b> (U of California, Los Angeles) Hedging in spoken and written academic discourse in Mandarin Chinese
9:45-10:15	<b>Cao, Rui</b> (U of Tokyo) Locative alternation in Mandarin Chinese	<b>Lee, So Young; Wu, Hongchen; Liu, Lei &amp; Yun, Jiwon</b> (Stony Brook U) Asymmetric prosodic effect on production and perception of Mandarin <i>wh</i> -scope	<b>Wang, Ran</b> (U of Buffalo) Numeral classifiers and their pragmatic functions in Mandarin noun phrases
10:15-10:30	<b>Coffee/Tea Break</b> (Pfahl Third Floor Foyer)		

<b>Sun. 03/11/2018 Session 8. 10:30-12 :30</b>			
	<b>Session 8-A</b> (Pfahl 330) Segmental & Prosodic Research	<b>Session 8-B</b> (Pfahl 340) Morphosyntax & Semantics	<b>Session 8-C</b> (Pfahl 240) Experimental & Corpus Research II
	Chair: Chen, Litong	Chair: Alves, Mark	Chair: Tao, Liang
10:30-11:00	<b>Chang, Yufen</b> (Western Kentucky U) Frequency of Taiwanese tone sandhi in a spoken corpus with some implications	<b>Kang, Hana</b> (U of Notre Dame) Chinese learners' reading process of Chinese words: A case study of on-line sentence processing	<b>Zhang, Liang; Li, Aijun &amp; Luo, Yingyi</b> (Chinese Academy of Social Sciences) The role of causal conjunction in Chinese sentence processing with different linear orders: Evidence from corpus analysis and eye tracking
11:00-11:30	<b>Yang, Seojin</b> (Ohio State U) A comparative study of rhotacization in open syllables in Mandarin Chinese between northern and southern speakers	<b>Zhang, Lynn</b> (U of Wisconsin – Madison) Examining the syntactic category of “wèi” in Mandarin Chinese: A verb, preposition or co-verb?	<b>Grano, Thomas &amp; Zhang, Yiwen</b> (Indiana U) Getting aspectual <i>-guo</i> under control in Mandarin Chinese: An experimental investigation
11:30-12:00	<b>Pan, Junquan</b> (Ohio State U) Constructing sexuality: A sociophonetic study of a LGBT talk show in Taiwan	<b>Pavlova, Alena</b> (Moscow City U) Combinatorial method in researching the functions of the sentence-final particles (utterance particles)	<b>Wiener, Seth</b> (Carnegie Mellon U) & <b>Rohde, Hannah</b> (U of Edinburgh) Immediate integration of real-world knowledge and classifier cues during Mandarin sentence processing
12:00-12:30	<b>Mu, Bing &amp; Cornelius, Crista</b> (Ohio State U) Comparison of native and non-native speakers' production of Mandarin Tone 2	<b>Chen, Chung-yu</b> (U of Illinois at Urbana-Champaign) Termination or completion in Mandarin perfective accomplishment VPs: An experimental study	<b>Shen, Jingdi</b> (Ohio State U) Analysis of regional lexical variants in Mandarin social media data
12:20-12:40	<p align="center"><b>Conference Closing Remarks</b> (Pfahl 330)</p> <p align="center">NACCL-30 Organizing Committee Chairs</p> <p align="center"><b>Thank you for coming to NACCL-30. Have a safe trip home!</b></p>		

# The Ohio State University Campus: Walking Route Between The Blackwell Inn and Mershon Center.

It is a one-mile, 20-minute walk south from The Blackwell Inn (2110 Tuttle Park Place), primarily along Neil Avenue, to Mershon Center (1501 Neil Avenue) for the two Pre-Conference Workshops, to be held on March 8 from 2:30-7:00 p.m.

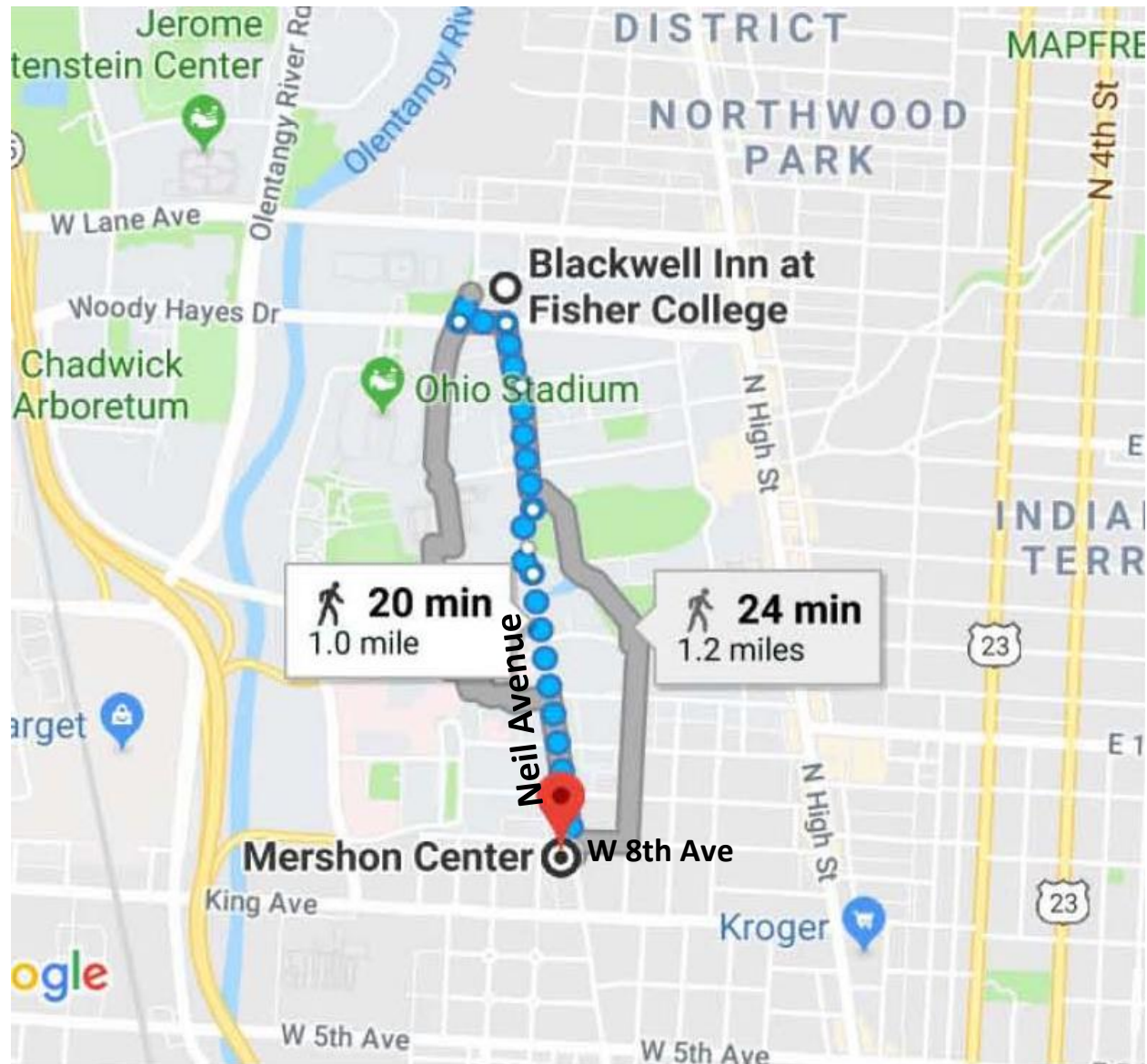

Map data ©2017 Google 2000 ft

The Blackwell Inn (2110 Tuttle Park Place) and Pfahl Hall (280 W. Woodruff Avenue)

## The Blackwell Inn at The Ohio State University

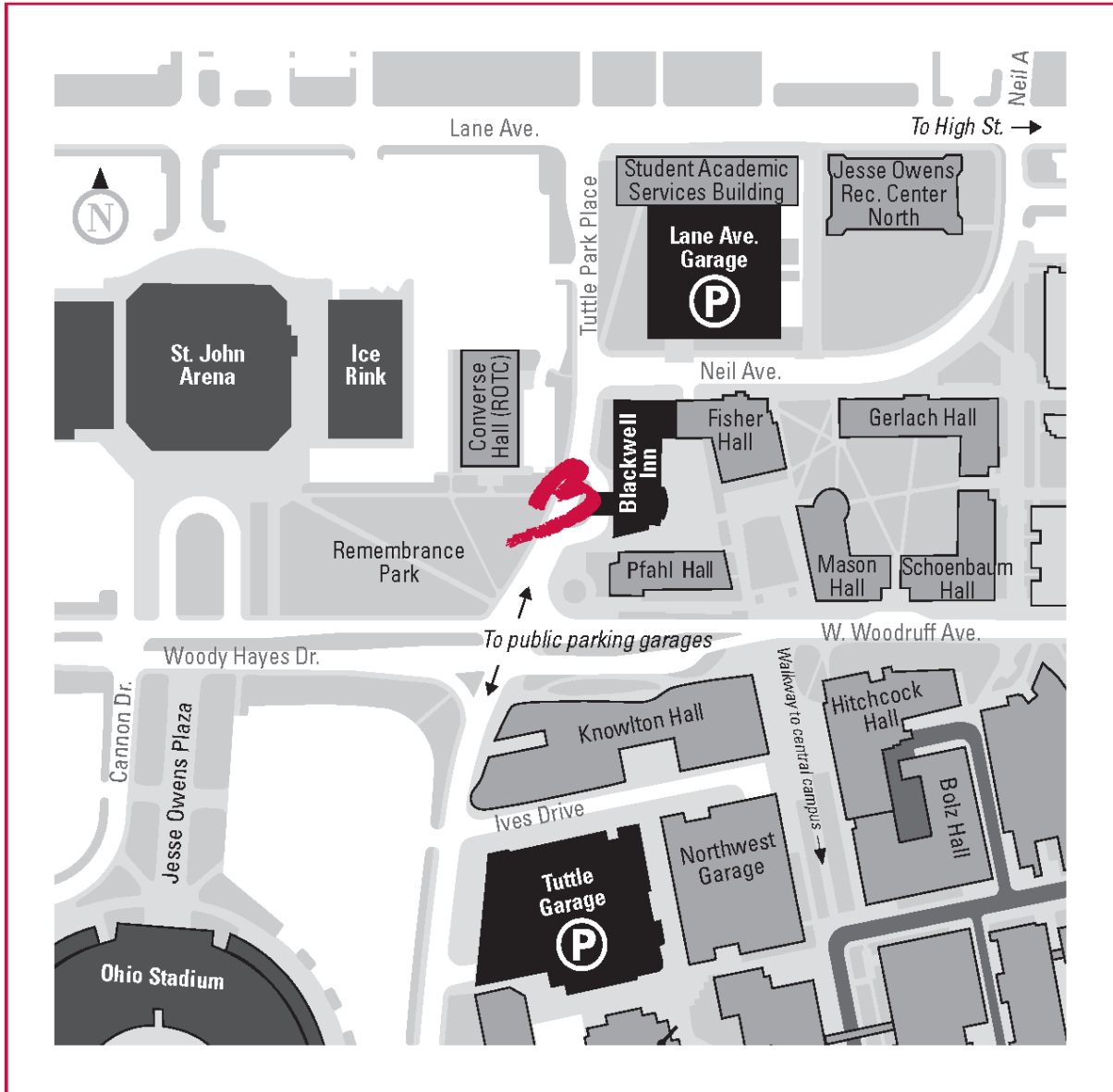

### Parking for The Blackwell Inn

#### ~ Valet

Valet parking is available at the entrance to the hotel.

#### ~ Garage Parking

The Lane Avenue Parking Garage is located just north of the hotel.

The Tuttle Park Garage is located one block south of the hotel.

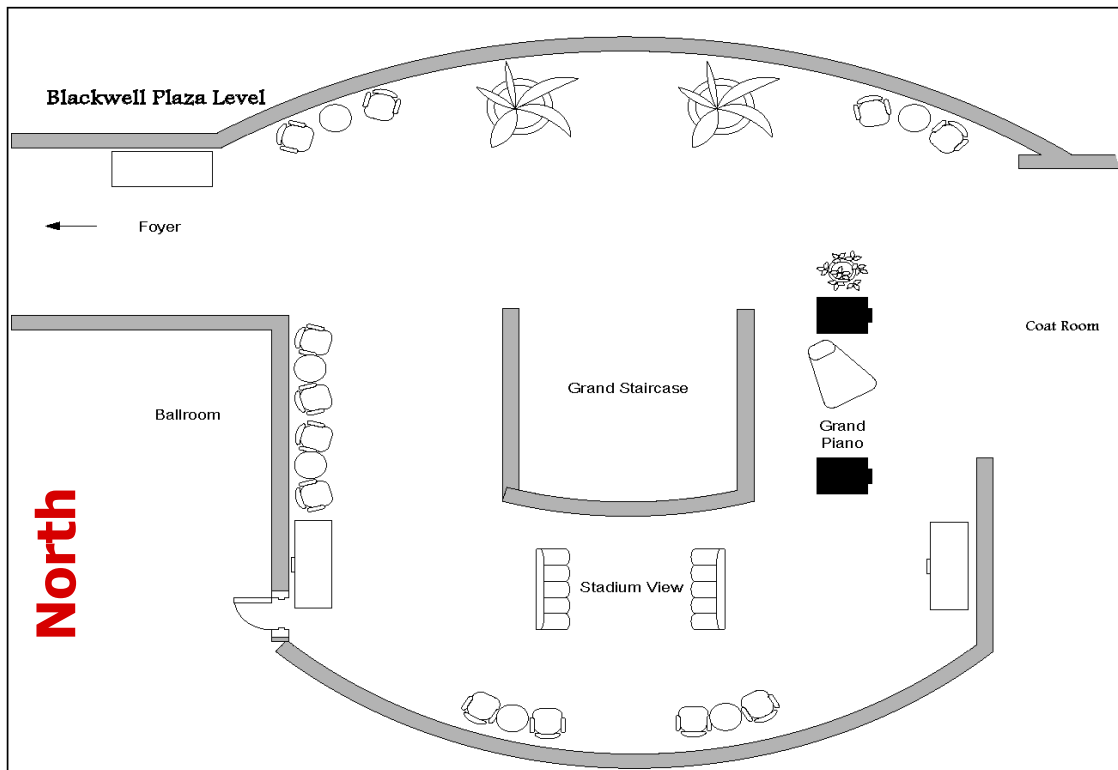
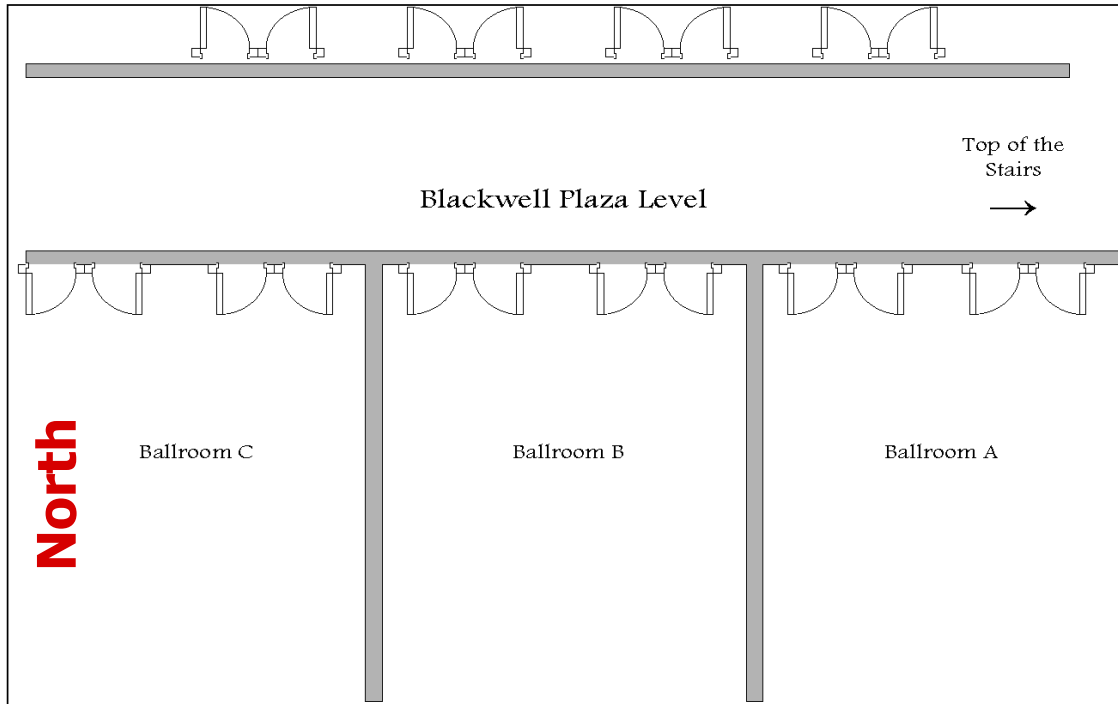



## Pfahl Hall – 3<sup>rd</sup> Floor

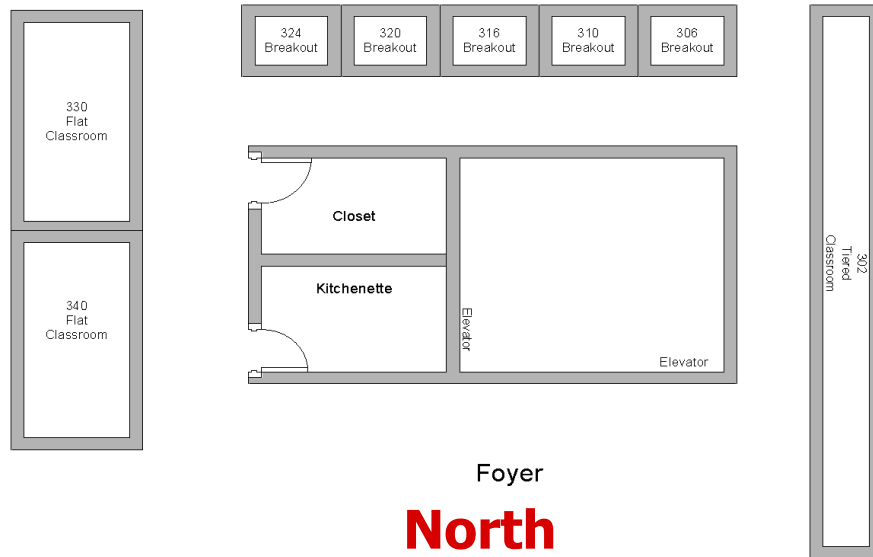

## Pfahl Hall – 2<sup>nd</sup> Floor

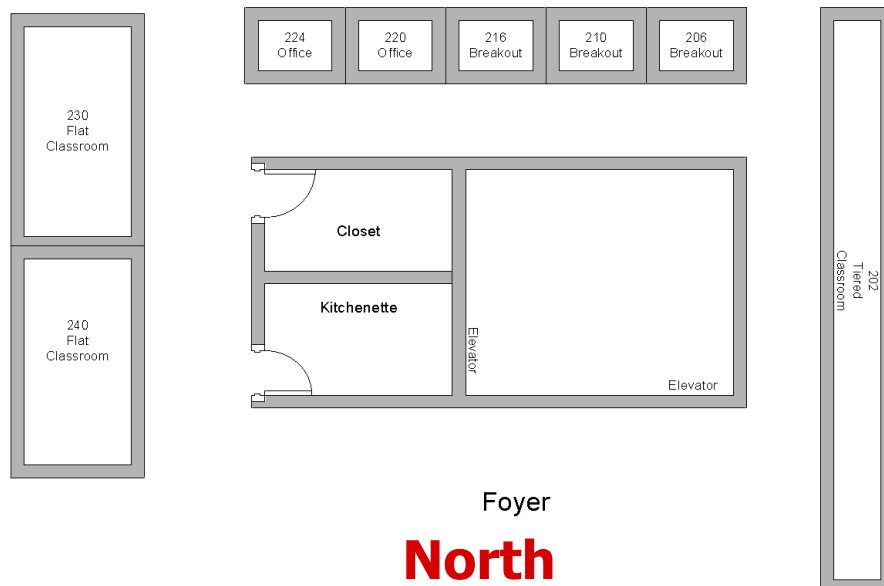



# Pfahl Hall – 1<sup>st</sup> Floor

